

PARIVAR ENCLAVE AFFORDABLE HOUSING

Punjab's 1st Affordable Housing Scheme Near Chandigarh

Near Aerocity Mohali

Adjoining PR-11, Chandigarh International Airport Road, Derabassi

APPROVED BY 

Invites Application for Allotment of
25 Residential Plots
in Sector 22, Derabassi, **Dist. MOHALI**

SCHEME STARTS
1st June, 2025

SCHEME ENDS
10th June, 2025

DRAW ON
11th June, 2025



PROJECT FEATURES

ADJOINING 500 ACRES FOREST RESERVE
GATED SOCIETY | PRIME LOCATION | AIRPORT CONNECTIVITY
WIDE INTERNAL ROADS | INDOOR & OUTDOOR SPORTS | GYM & CLUB HOUSE
24X7 SECURITY & MANY MORE...

REFUNDABLE

Application Fees Rs. 5,000/-

HOME LOAN AVAILABLE UPTO 75%

EMI AS LOW AS ₹661/- per day

APPLY ONLINE NOW

SCAN QR CODE



OR LOG ON TO

www.affordablehousingcheme.com

SCHEME OPEN FOR

**Govt. Employees | Semi Govt. Employees | Female Category
Defence Personnel | Health Workers**

ELIGIBILITY

The Applicant must be a resident of India and must be atleast 18 years old as on the last date of submission of the application

Please note that only one application per individual will be considered; duplicate entries under the same name will be rejected.



www.affordablehousingscheme.com

APPROVED BY  **SBI**

ABOUT PROJECT



**AFFORDABLE RESIDENTIAL PLOTS
IN SECURED GATED TOWNSHIP
ADJOINING 500 ACRES FOREST RESERVE
AND PR11 CHANDIGARH AIRPORT ROAD**



TOWNSHIP FEATURES



Grand Central Park
with lush landscaping



Cricket Practice
Pitch



Volleyball Court
and tennis court



Yoga / Meditation
Garden with Gazebo



Basketball Cum
Skating Rink



Badminton
Court



Amphitheatre



Club House



Indoor
Gym



Outdoor
Gym



Table Tennis
and Billiards



Chess / Carrom /
Cards Room



24x7 security &
CCTV surveillance



Sewage systems
with STP



Grand Entrance Gates

40%

40% open area

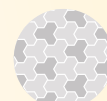

Wide Cement
Paved Roads



High Street
Retail Market





LOCATION MAP



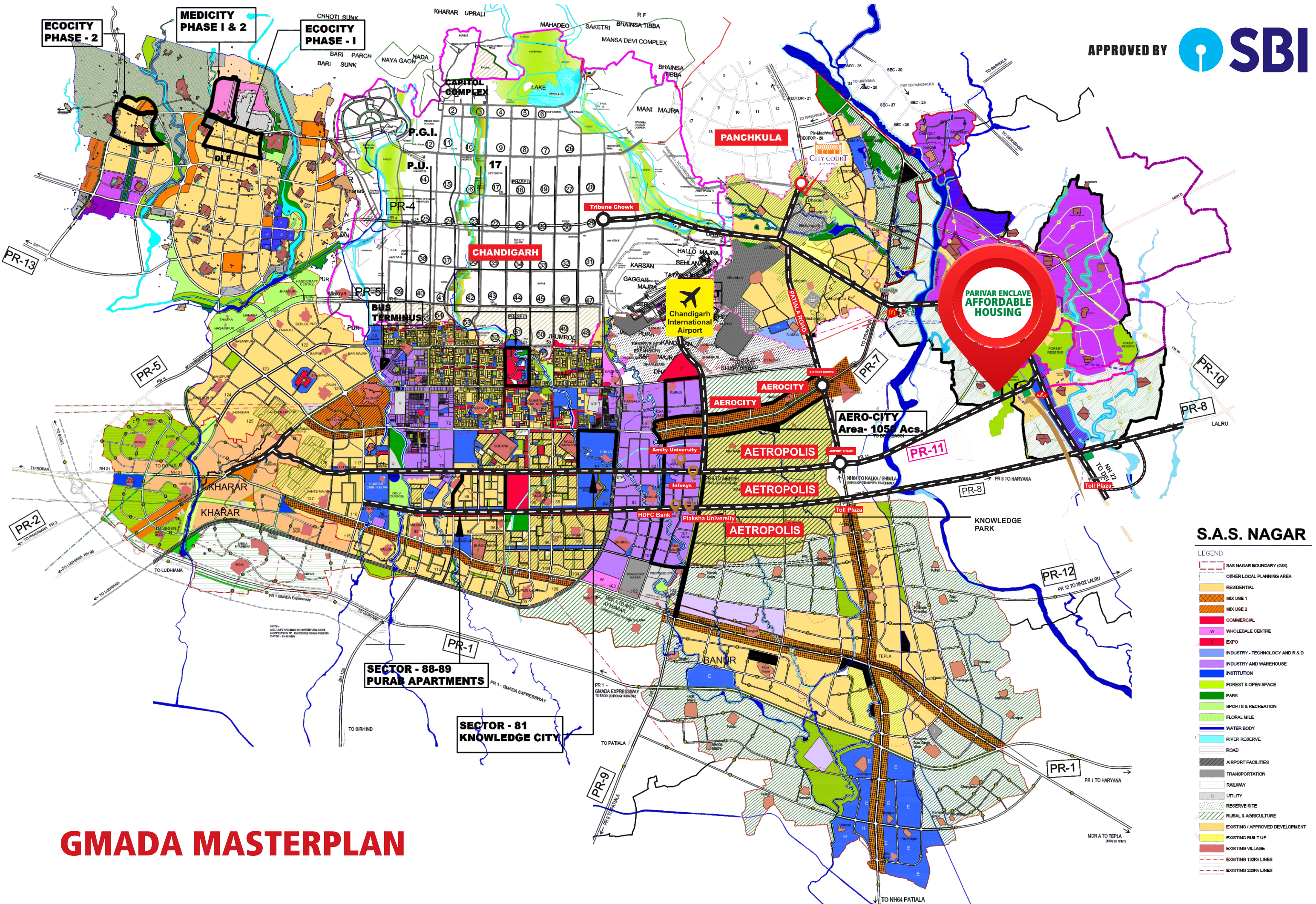

GMADA MASTERPLAN

APPROVED BY



SITE PLAN

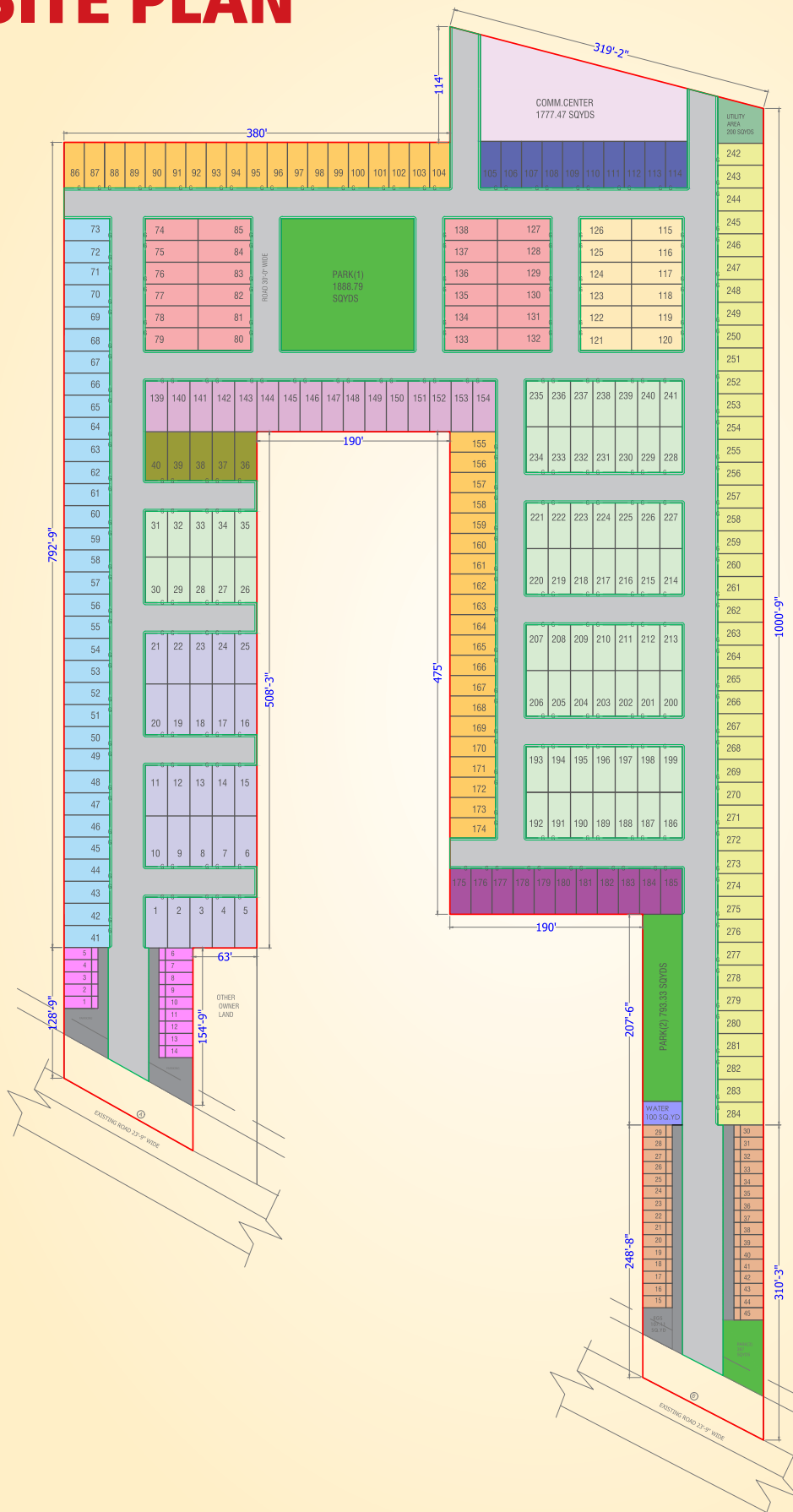

- PLOT NO. = 1-25 (22'-0"X50'-0" = 122.22 SQ.YDS.)
- PLOT NO. = 26-35 (22'-0"X45'-0" = 110 SQ.YDS.)
- PLOT NO. = 36-40 (22'-0"X48'-3" = 117.94 SQ.YDS.)
- PLOT NO. = 41-73 (21'-9"X45'-0" = 108.75 SQ.YDS.)
- PLOT NO. = 74-85 (21'-6"X52'-0" = 124.22 SQ.YDS.)
- PLOT NO. = 86-104 (20'-0"X45'-0" = 100 SQ.YDS.)
- PLOT NO. = 105-114 (21'-3"X46'-0" = 103.5 SQ.YDS.)
- PLOT NO. = 115-126 (20'-9"X50'-0" = 119.44 SQ.YDS.)
- PLOT NO. = 127-138 (21'-6"X52'-0" = 124.22 SQ.YDS.)
- PLOT NO. = 139-154 (21'-9"X50'-0" = 118 SQ.YDS.)
- PLOT NO. = 155-174 (20'-0"X45'-0" = 100 SQ.YDS.)
- PLOT NO. = 175-185 (21'-9"X45'-0" = 103.75 SQ.YDS.)
- PLOT NO. = 186-241 (22'-0"X45'-0" = 110 SQ.YDS.)
- PLOT NO. = 242-284 (22'-6"X45'-0" = 112.5 SQ.YDS.)

- ROADS
- PARKS
- COMMUNITY CENTER (1777.47 SQ.YDS.)
- UTILITY AREA 200 (SQ.YDS.)
- WATER (100 SQ.YDS.)

- SHOP NO. = 1-14 (12'-0"X33'-6" = 44.66 SQ.YDS.)
- SHOP NO. = 15-45 (12'-0"X29'-0" = 38.66 SQ.YDS.)
- PARKING
- EGS (107.11 SQ.YDS.)



DETAILS OF OFFERED UNITS FOR ALLOTMENT UNDER SCHEME

Numbers of Plots	Plot Size (Sq.yards)	Plot Dimension	Rate / Sq.yard	Basic Sale Price	Exclusive Offer (10% DISCOUNT)	Net Price
10	103.8	20'9" x 45'	₹31,950/-	₹33,14,813/-	₹3,31,481/-	₹29,83,331/-
10	110	22' x 45'	₹31,950/-	₹35,14,500/-	₹3,51,450/-	₹31,63,050/-
5	122.2	22' x 50'	₹31,950/-	₹39,04,929/-	₹3,90,493/-	₹35,14,436/-

*Additional charges like EDC/ IFMS, Club charges, MMC, Government taxes are over and above the mentioned price.

SPECIAL BENEFIT
UNDER THIS SCHEME

10% DISCOUNT

Application Fee Rs. 5,000/- (Refundable)





IMPORTANT DATES

Scheme Starts	1st June, 2025
Last Date of Submission of Application Form & Application Fees	10th June, 2025
Uploading the Successful Applicants on website www.affordablehousingScheme.com	11th June, 2025
Last Date for Depositing 10% Payment	17th June, 2025
Last Date for Depositing 15% Payment	24th June, 2025
Last Date of Submission of Full and final payment & Registration	5th July, 2025
REST IN EASY PAYMENT PLAN	

EMI AS LOW AS ₹661/- per day

www.affordablehousingScheme.com



APPLICATION DETAILS

SCAN THE CODE TO MAKE THE PAYMENT OF APPLICATION FEE ₹5,000

Payment of application fee can also be done via NEFT/RTGS/IMPS/Cheque deposit into the following bank account.

A/c name: AMJAY INFRA

Account No: 924020017979491 Bank: AXIS Bank

IFSC CODE: UTIB0003524

Branch Address: Sector 7, Panchkula



OTHER TERMS & CONDITIONS

- 1) An applicant can apply only for one property in each category. Multiple applications from a single applicant in the same category may be rejected and the company shall not be liable to pay any interest in this regard.
- 2) No documents are to be submitted along with the application.
- 3) If the information/documents supplied are found to be false or fabricated such allotment shall be cancelled and Parivar Enclave Affordable Housing Scheme shall reserve rights to initiate civil or criminal proceedings against the applicant. Incomplete applications will be summarily rejected without conveying reasons.
- 4) Submission of Documents: Those applications who are successful in the uploaded list will be required to submit documents in person or through registered post by the date mentioned in the brochure. Applications for which supporting documents are not submitted by the applicants in time, will be rejected and next applicant in the waiting list may be considered. No claims, whatsoever, shall be entertained thereafter.
- 5) Application fee shall be paid only through NEFT/ RTGS/ Online Transfer or online gateway mentioned on the website.
- 6) In case, applicant seeks refund of his application fee before 10th June the same shall be refunded in full. However, no interest on the deposited amount shall be paid. All refund request will only be accepted via email address registered by the applicant. No refunds request shall be entertained after 10th June, 2025. Refunds shall remain applicable only till 10.06.2025
- 7) For a successful applicant, in case of failure to make next 10% payment within stipulated period, allotment shall be deemed to be cancelled, However, this period can be extended up to 10 days subject to payment of penalty and surcharge as fixed by the Parivar Enclave Affordable Housing Scheme from time to time.
- 8) Surcharge on delayed payment shall be charged @ 1.5% for 30 days delay, 2% for 60 days delay, 2.5% for 90 days delay, 3% for 180 days of delay per month.

PARIVAR ENCLAVE AFFORDABLE HOUSING
Punjab's 1st Affordable Housing Scheme
Near Chandigarh

Near Aerocity Mohali



APPLY ONLINE NOW

SCAN QR CODE



OR LOG ON TO

www.affordablehousingscheme.com

CALL: 75085 70099